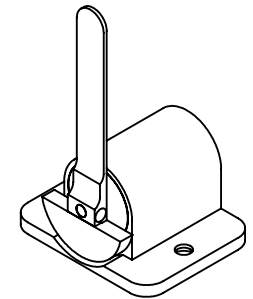
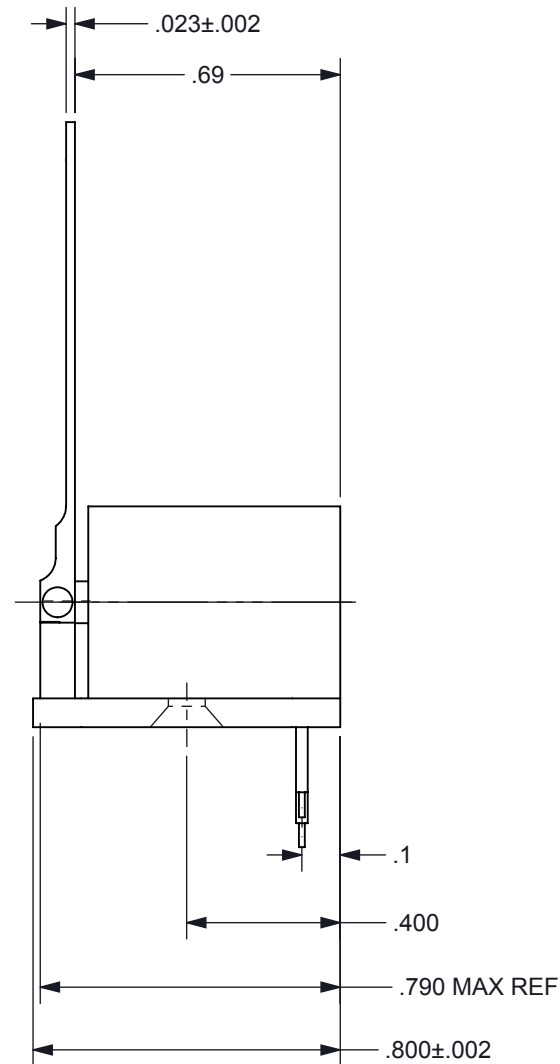

FIGURE 1



**PROPRIETARY DOCUMENT**

**SPECIFICATIONS**

1. PRODUCT TYPE	BI-STABLE SHUTTER
2. TEMPERATURE	-40° C TO +85° C OPERATING RANGE
3. TRAVEL	29 ± 2° CCW FROM POSITION SHOWN IN FIGURE 1
4. ROTATION	CCW / RED (+) BLACK (-), CW / RED (-) BLACK (+)
5. VOLTAGE	24 VDC (PULSE FOR 50 MS)
6. COIL	750Ω ± 10% @ 25°C (CLASS H)
7. LEADS	RED AND BLACK 30 ET TEFLON INSULATED WIRE PER M16878/6
8. LEAD LENGTH	12" MINIMUM, STRIPPED 1/4" ± 1/8" AT BOTH ENDS
9. HOUSING FINISH	BLACK ANODIZE PER MIL-A-8625F, TYPE II, CLASS II
10. SHUTTER FINISH	BLACK ANODIZE PER MIL-A-8625F, TYPE II, CLASS II

DIMENSION TOLERANCES UNLESS OTHERWISE SPECIFIED ANGLES ± 1° 2 PLACES ± .010 FRACTIONS ± 1/32 3 PLACES ± .005 1 PLACE ± .015 4 PLACES ± .0005					
MATERIAL: N/A		DRAWN: P.T.			
FINISH: N/A		CHECKED: C.G.S.			
DATE: 10/13/11	SCALE: NONE	APPROVED: T.G.A.			
TITLE: BI-STABLE SHUTTER		DWG NO: A1031	SHEET: 1 of 1	REV: A	